

BENCH STOPPER

SEMI AUTOMATIC STOPPERING



- Semi-automatic, accurate insertion of rubber stoppers
- Capacity up to 1,300 per hour
- No contact between stopper and operator
- For use in existing laminar air flow cabinets or isolators
- An ideal and very flexible solution for biotech or pharmaceutical industries

Watson-Marlow Flexicon

Frejasvej 2-6
DK-4100 Ringsted
Denmark
Tel. +45 57 67 11 55
Fax. +45 57 67 05 41
flexicon@flexicon.dk
www.wmflexicon.dk



BENCH STOPPER TECHNICAL SPECIFICATIONS

A bench stopper from Watson-Marlow Flexicon is the ideal solution for companies within the pharma or biotech industry, which require very flexible, easy to use equipment for accurate positioning of stoppers in small batches.

The bench stopper is designed for use inside an existing laminar airflow cabinet.

Together with FF20, MC12, PD12 and FS10 it constitutes a system, which allows for a very fast change-over between batches with different liquids, vials, stoppers and caps.

The bench stopper consists of two units:

- The stoppering unit to be placed inside the laminar airflow cabinet
- A control box for electronic and pneumatic components. This is to be placed outside the laminar air-flow cabinet.

The stoppering unit is equipped with customized vibrator feeding bowls and other format parts for the stoppers to be applied. Also format parts for the vials to be applied will be delivered with the unit.

The stopper format parts are made of stainless steel AISI316L and vial format parts are made of Polycetal.

All format parts can be mounted by the operator in less than 5 minutes without using tools.

During operation the operator places a vial in the bottle grip (pos. 4) and the stoppering will be done automatically, when a foot pedal is activated.

The capacity is depending on the operator. 1,300 vials per hour can be obtained.

The unit is designed according to the latest GMP-guidelines.

Max. size of stoppers:
Ø20 mm

Max. size of vial::
100 ml (Ø52 x 100)

Mains:
110/230 VAC earthed

Power consumption:
Max. 400 W

Compressed air:
Max. 25 l/min

Ingress protection:
IP 42

Weight:
Stopper unit: 60 kg
Control box: 30 kg

Dimensions:
Control unit (LxWxH): 220 x 400 x 750
Stopper unit: See below drawing

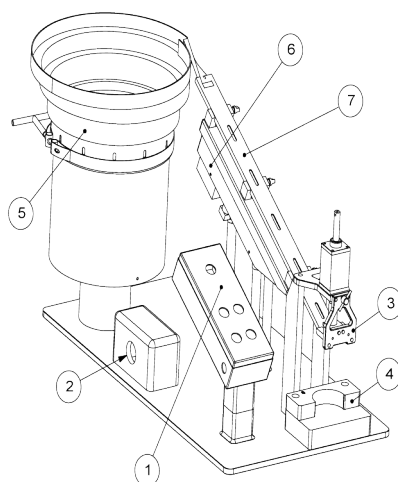

1. Control panel
2. Service Connections
3. Stopper insertion
4. Bottle grip and height adjustment
5. Circular vibrator with stopper bowl
6. Linear vibrator with stopper chute
7. Stopper chute

