



Improving your PERFORMANCE

621DF/RA, 621DF/REA, 621DF/RE4A ATEX pumps

Technical information

- ATEX Category II Group 2 Gas max surface temperature 135C (II 2G c IIB T4) fixed speed pump assembly
- 620R uses 3.2mm wall thickness continuous tubing, 620RE and 620RE4 use LoadSure tube elements
- One minute maintenance from patented LoadSure technology
- Pumphead rotor has two spring-loaded rollers that disengage for CIP/SIP
- Pumpheads have shock proof tool-lockable guard with safety interlock option
- Fixed speed or variable frequency drive* motor options
- 0.18kW 230/400V 3 phase 50Hz TEFC EExd IIB T4 geared units with or without positive temperature coefficient (PTC) thermistors
- Three 0.37kW variable frequency drive options available with various control functionality



10:1 speed reduction at 77rpm, 2:1 at 251rpm available using VFD from geared units, must be fitted with thermistors



Flow rates at transfer pressure with water at 20C (litres/min)

Tube bore and flow rates (litre/min)	Elements								
	Material	Fixed rpm	620R continuous tubing				620RE LoadSure		620RE4 LoadSure
		6.4mm	9.6mm	12.7mm	15.9mm	12.0mm	17.0mm	12.0mm	17.0mm
Marprene, Bioprene TM	77/251					2.9/9.3	4.5/14.8	2.4/7.9	3.2/10.3
Marprene, Bioprene TL	77/251	1.0/3.3	1.9/6.3	3.1/10	4.2/11	2.9/9.3	4.7/16.9	2.4/7.9	3.6/11.8
Pumpsil Platinum Silicone Neoprene, STA-PURE,	77/251	0.92/3.0	2.1/6.8	3.2/11	4.7-14	3.0/9.7	4.7/15	2.5/8.3	3.3/11
Chem-Sure	77/251	0.92/3.0	1.9/6.3	3.1/10	4.7-15	3.1/10.0	5.6/18	2.6/8.5	3.9/13

Pumphead/tube/fluid: 620RE 17mm LOADSURE/Water
Tube material: Sta-Pure Fluid viscosity: 1.0 centipoise

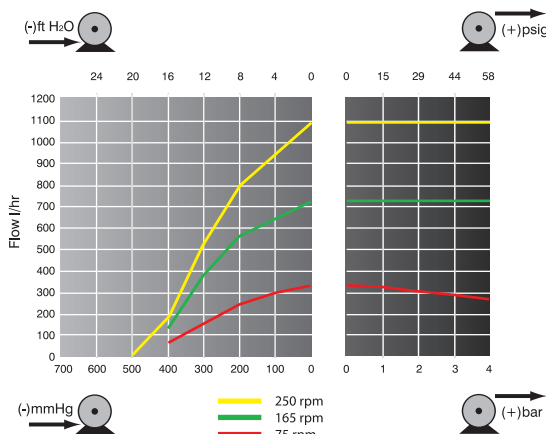

251 rpm model

77 rpm model

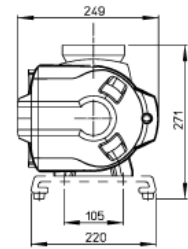
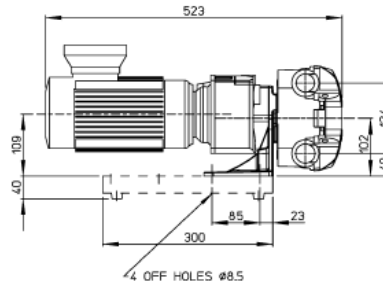
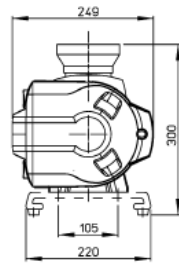
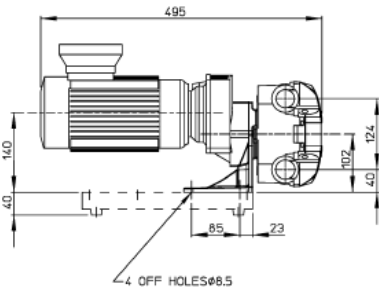

621DF/RA, 621DF/REA, 621DF/RE4A ATEX pumps

Order information			
Pump	rpm	Supply	Product code
621DF/RA	77	230/400V 50Hz 3ph 0.37kW	060.8322.020
ATEX fixed speed	251	230/400V 50Hz 3ph 0.37kW	060.8352.020
621DF/REA	77	230/400V 50Hz 3ph 0.37kW	060.8322.E20
ATEX fixed speed	251	230/400V 50Hz 3ph 0.37kW	060.8352.E20
621DF/RE4A	77	230/400V 50Hz 3ph 0.37kW	060.8322.E40
ATEX fixed speed	251	230/400V 50Hz 3ph 0.37kW	060.8352.E40
621DF/RA	77	230/400V 50Hz 3ph 0.37kW	060.8622.020 - *10:1
ATEX fixed speed PTC's	251	230/400V 50Hz 3ph 0.37kW	060.8652.020 - *2:1
621DF/REA	77	230/400V 50Hz 3ph 0.37kW	060.8622.E20 - *10:1
ATEX fixed speed PTC's	251	230/400V 50Hz 3ph 0.37kW	060.8652.E20 - *2:1
621DF/RE4A	77	230/400V 50Hz 3ph 0.37kW	060.8622.E40 - *10:1
ATEX fixed speed PTC's	251	230/400V 50Hz 3ph 0.37kW	060.8652.E40 - *2:1

*10:1 or 2:1 speed reduction available using VFD from geared units fitted with PTC thermistors

Pumphead ordering codes		
Pumphead	Description	Product code
620RA	Two roller continuous tubing pumphead for maximum 2bar peak pressure	064.0211.A00
620REA	Two roller LoadSure element pumphead for maximum 4bar peak pressure	064.0231.A00
620RE4A	Four roller LoadSure element pumphead for maximum 4bar peak pressure	064.0431.A00

Variable frequency drive ordering (0.37kW)			
Inverter	Filter	Supply	Product code
Micromaster Compact "Plus"	Class B	230/400V 50/60Hz 3ph	079.4037.1FP
Micromaster Compact "Basic"	Class A	230/400V 50/60Hz 3ph	079.4037.1FB
Micromaster Compact "Vector"	Class A	230/400V 50/60Hz 3ph	079.4037.1FV

Specification

Weight	20kg max
Ingress protection	IP55 geared unit
Operational temperature range	5°C to 40°C
Noise	< 70dB(A) @ 1m
Control ratio	10:1 for motors fitted with thermistors
Standards	CE, EN60529 (IP55), EN50014, EN13463-1:2001
Supply	230/400V 50Hz 3 phase

Materials of construction

Motor	Cast aluminium alloy
Gearbox	Cast iron
Track	aluminium alloy - powder coated
Rotor hub, roller arms	Polyphenylene Sulphide (PPS)/10% Celstran SF50
Link arm	Polyphenylene Sulphide (PPS)
Tube clamps	Polypropylene
Earth lead	Copper – tin plated
Main roller assembly and springs	Stainless steel 303S31
Roller spindles, pins, thrust washer	Stainless steel 303S31
Follower rollers	MOS2 filled Nylon
Guard	Polyamid shell, Polyurethane outer - carbon painted
Guard seal	Closed-cell Neoprene

Tubing 3.2mm wall tubing ordering codes			
Bore/wall (mm)	Bioprene	Marprene	Platinum Silicone
6.4x3.2	903.0064.032	903.0064.032	913.A064.032
9.6x3.2	903.0096.032	903.0096.032	913.A096.032
12.7x3.2	903.0127.032	903.0127.032	913.A127.032
15.9x3.2	903.0159.032	903.0159.032	913.A159.032
Bore/wall (mm)	Neoprene	STA-PURE	Chem-Sure
6.4x3.2	920.0064.032	960.0064.032	965.0064.032
9.6x3.2	920.0096.032	960.0096.032	965.0096.032
12.7x3.2	920.0127.032	960.0127.032	965.0127.032
15.9x3.2	920.0159.032	960.0159.032	965.0159.032

All flow rates shown were obtained pumping water at 20C (68F) with zero suction and delivery heads.

Watson-Marlow, Bioprene and Marprene are trademarks of Watson-Marlow Limited.

Disclaimer: The information contained in this document is believed to be correct but Watson-Marlow Limited accepts no liability for any errors it contains, and reserves the right to alter specifications without notice. © Chem-Sure and © STA-PURE is a registered trademark of W.L. Gore & Associates Inc.

Please state the product code when ordering pumps and tubing.



LoadSure elements				
Material	12mm Tri-Clamp 3/4" PVDF connectors	17mm Tri-Clamp 3/4" PVDF connectors	12mm C&G with PP 3/4" connectors	12mm C&G with PP 3/4" connectors
Bioprene TL 0-2 bar (peak)	903.0120.PFT	903.0170.PFT		
Bioprene TM 0-4 bar (peak)	903.M120.PFT	903.M170.PFT		
STA-PURE 0-4 bar (peak)	960.0120.PFT	960.0170.PFT		
Plat Silicone (0-2 bar peak)	913.A120.PFT	913.A170.PFT		
Marprene TL 0-2 bar (peak)			902.0120.PPC	902.0170.PPC
Marprene TM 0-4 bar (peak)			902.M120.PPC	902.M170.PPC
Plat Silicone 0-2 bar (peak)			913.A120.PPC	913.A170.PPC
Neoprene 0-2 bar (peak)			920.0120.PPC	920.0170.PPC

Watson-Marlow-Bredel Pumps

Falmouth

Cornwall

England

TR11 4RU

Tel: +44 (0) 1326 370370

Fax: +44 (0) 1326 376009

www.watson-marlow.com

Email support4gb@watson-marlow.co.uk